

SIDEVIEW OF OVERALL REHABILITATION  
 BRAIDAE STREET BRIDGE CITY OF ARROYO GRANDE 08/16

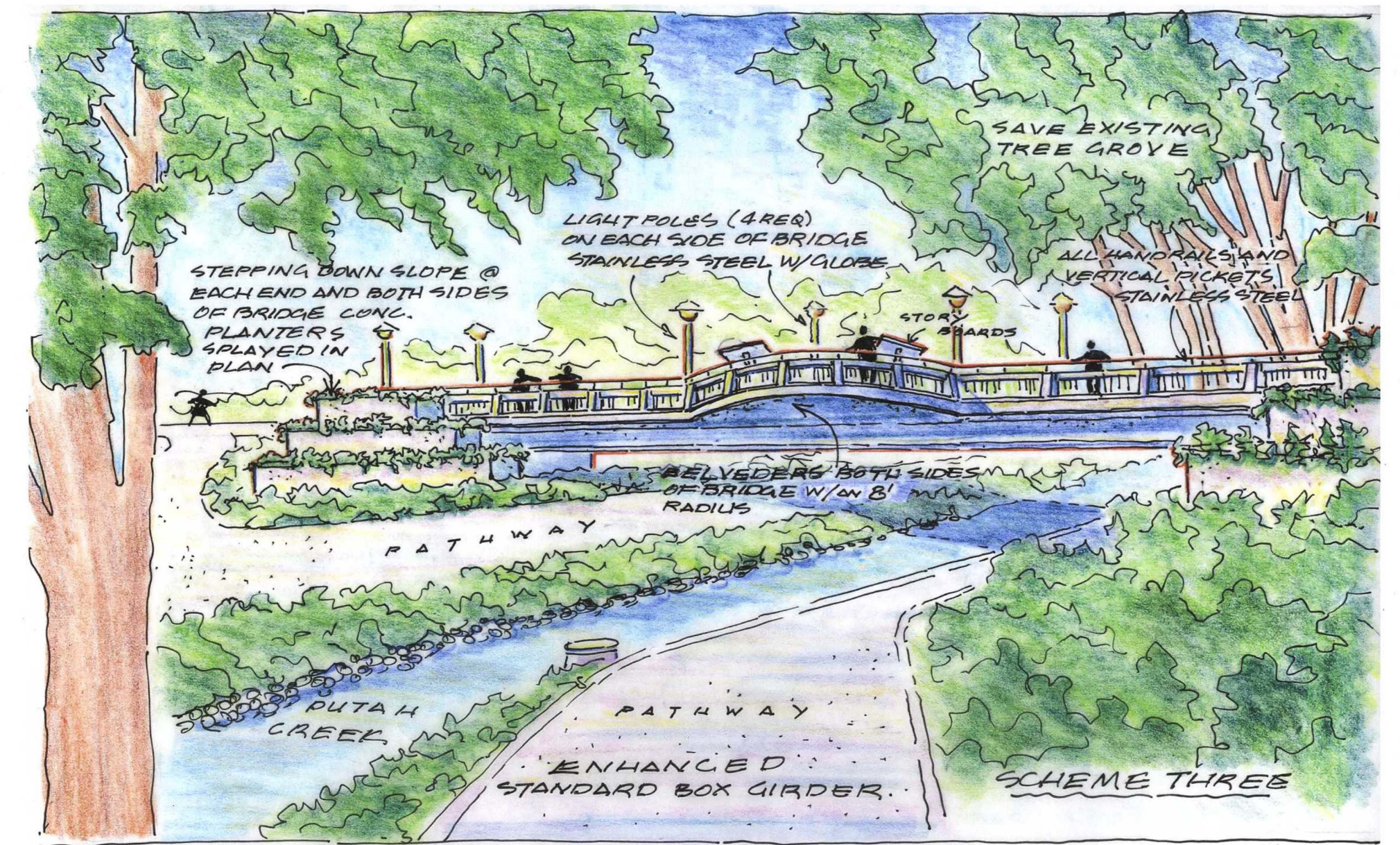

SCHEME THREE - CHICO'S SR 99 CORRIDOR  
 BIKE WAY BRIDGE CALIF. MAR 13/17



VIEW FROM PATHWAY OF  
 NEW LARUE ROAD BRIDGE UNIVERSITY OF CALIFORNIA  
 DAVIS MAY 16/14

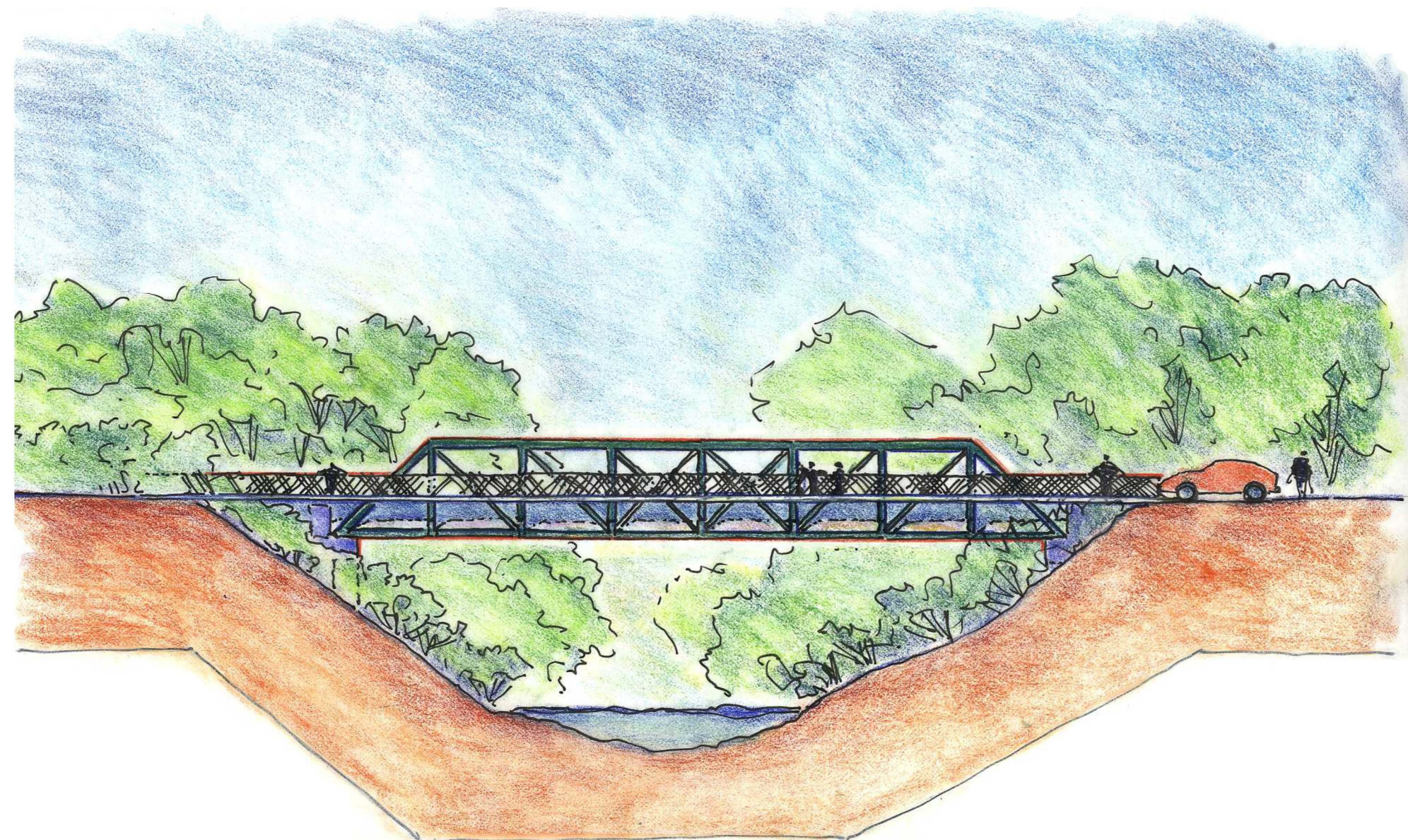

SIDEVIEW OF OVERALL REPLACEMENT  
 BRIDGE STREET BRIDGE CITY OF ARROYO GRANDE 08/16

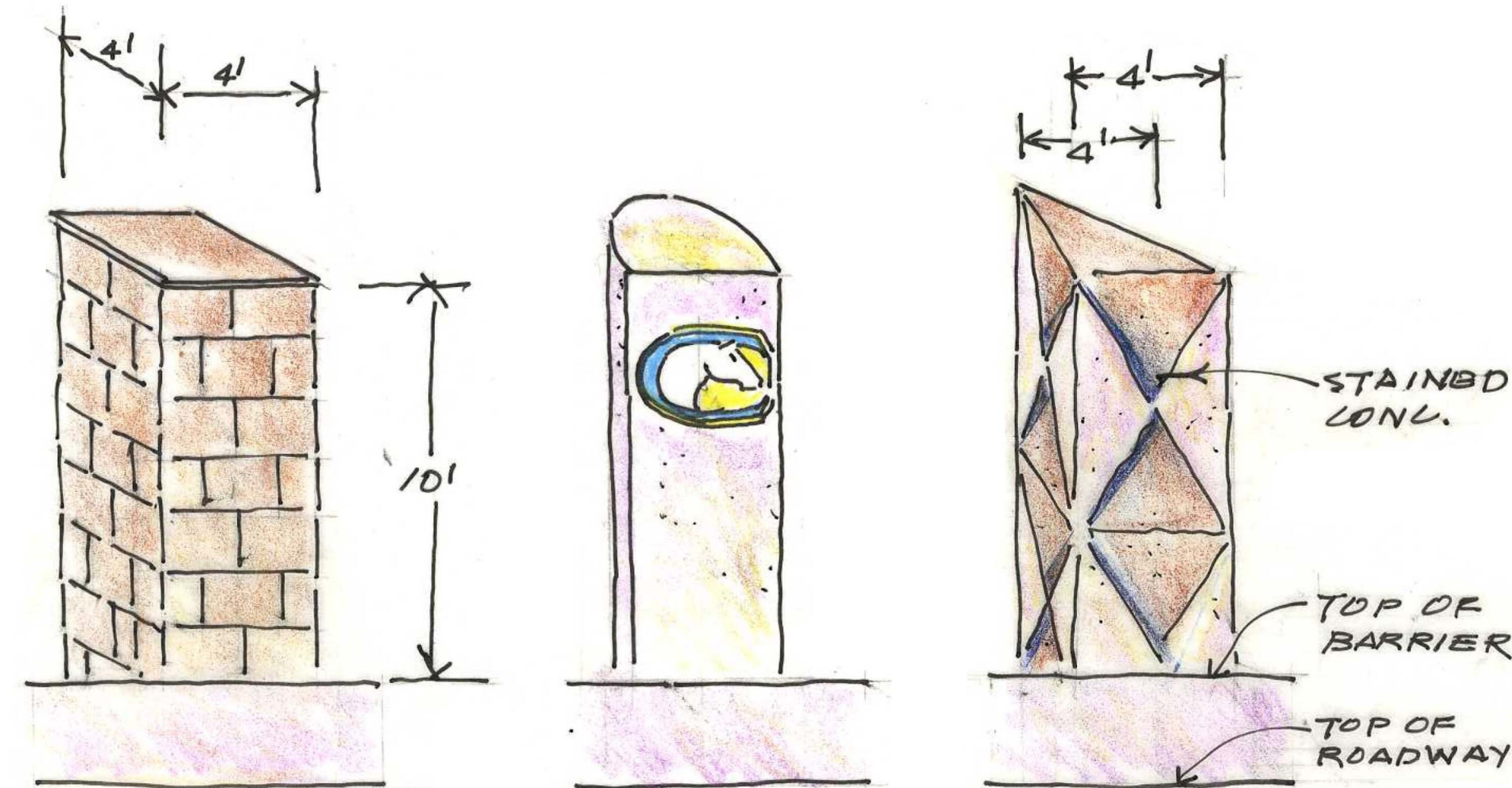

STONEWORK SIMILAR TO TILES ON  
 MONDAVI CENTER  
 PLAIN CONCRETE WITH UC DAVIS  
 LOGO  
 SCULPTURE FORM USING 26° SKEW  
 BRIDGEHEAD OPTIONS - LA RUE BRIDGE  
 DAVIS OCT 20/15

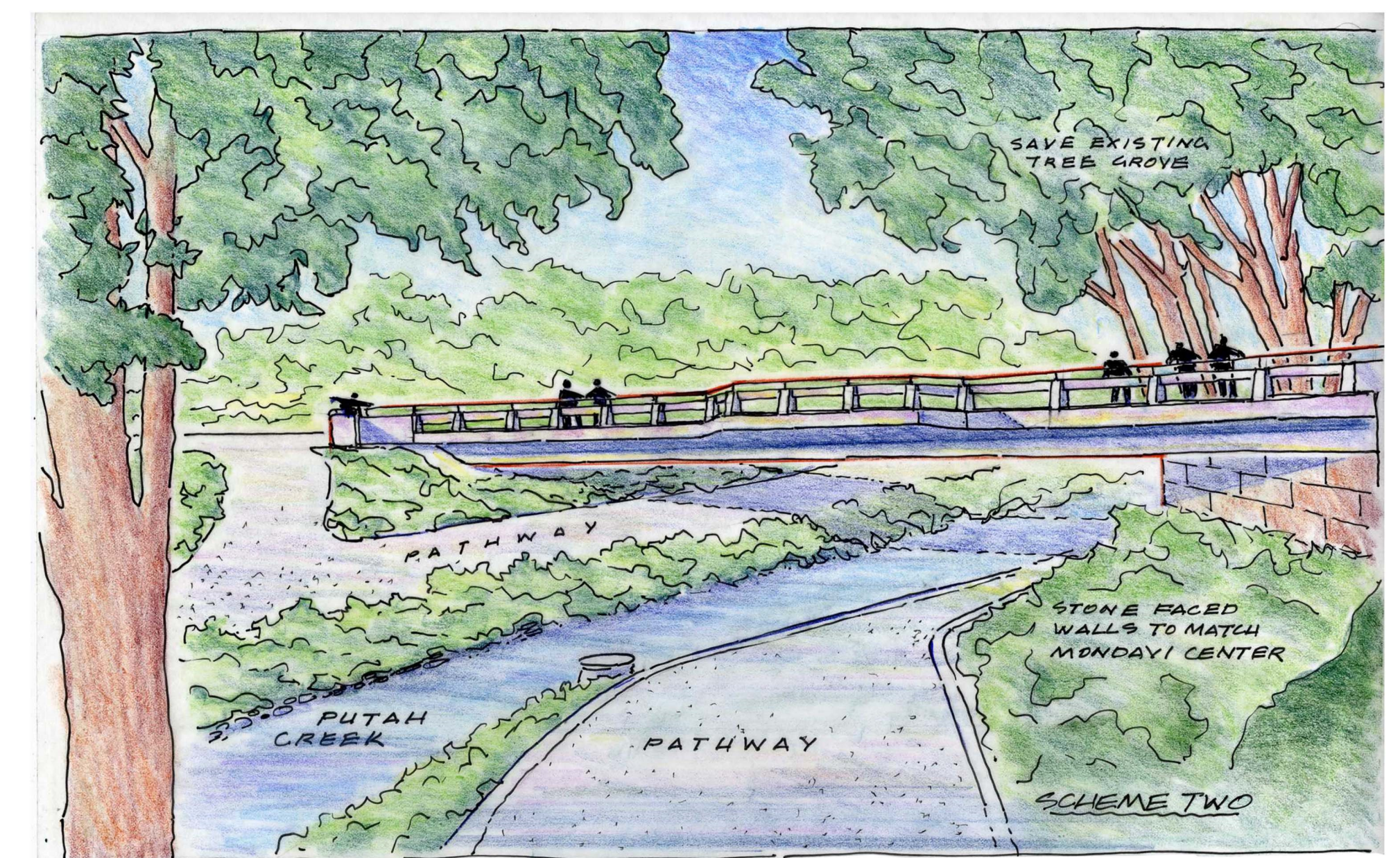

VIEW FROM PATHWAY OF  
 NEW LARUE ROAD BRIDGE UNIVERSITY OF CALIFORNIA  
 DAVIS MAY 14/14

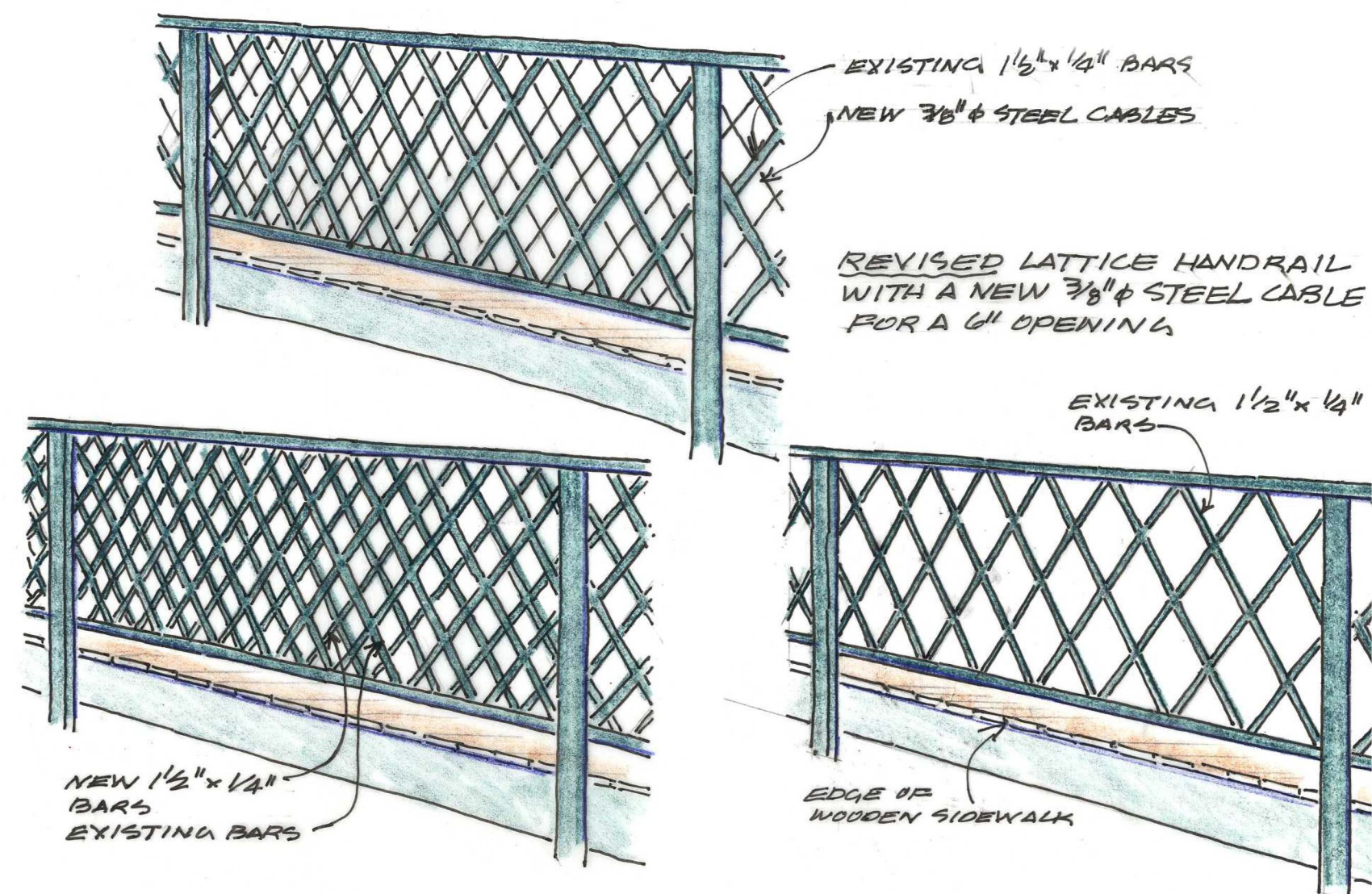

REVISIED LATTICE TYPE HANDRAIL  
 WITH NEW LATTICE MEMBERS  
 FOR A 6" OPENING  
 BRIDGE STREET BRIDGE CITY OF ARROYO GRANDE 08/16

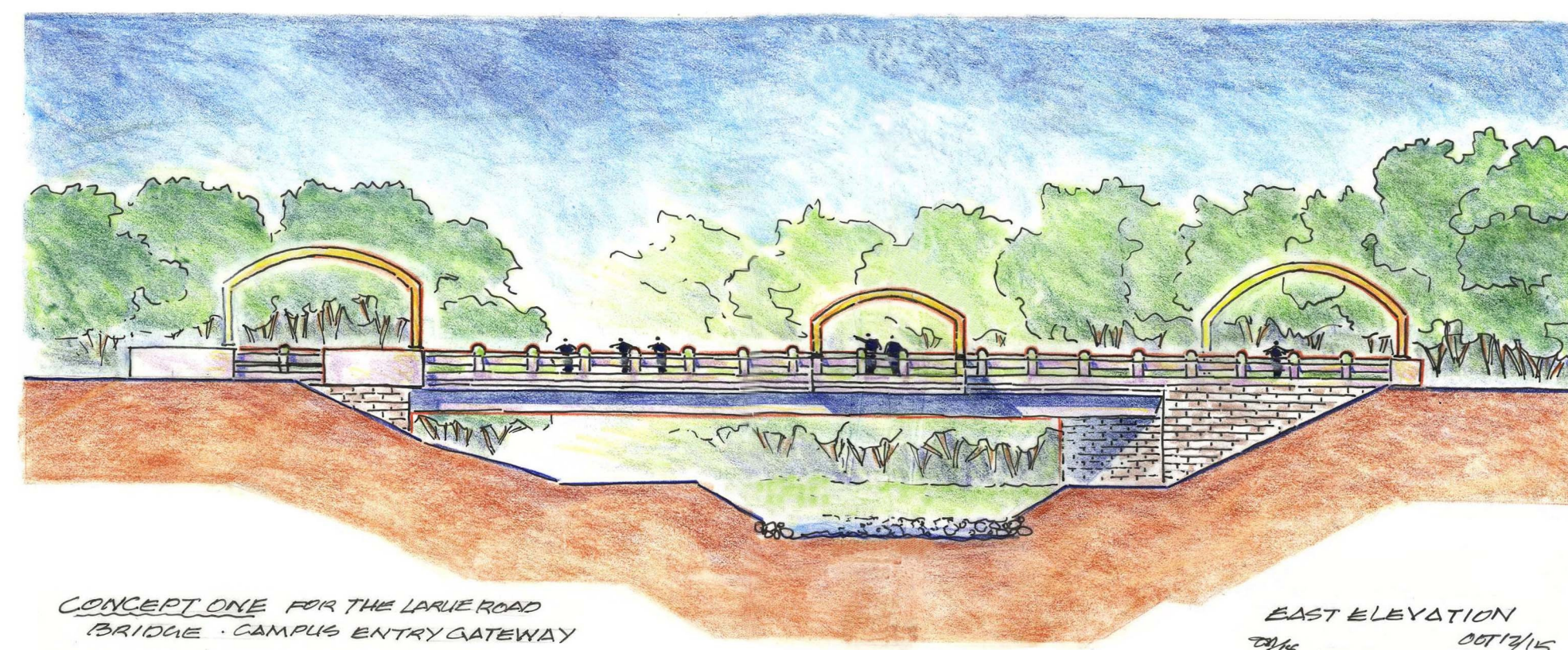

CONCRETE ONE FOR THE LARUE ROAD  
 BRIDGE - CAMPUS ENTRY GATEWAY  
 EAST ELEVATION 08/15

WIDE FLANGE STEEL  
 ARCHES FOR ENTRY  
 ARCHES ON THE  
 BELVEDERES AND  
 BRIDGE  
 VENEER FACED  
 BUTTRESS WALLS  
 WITH STONE TILES  
 TO MATCH THE TILES  
 OF THE MONDAVI  
 CENTER

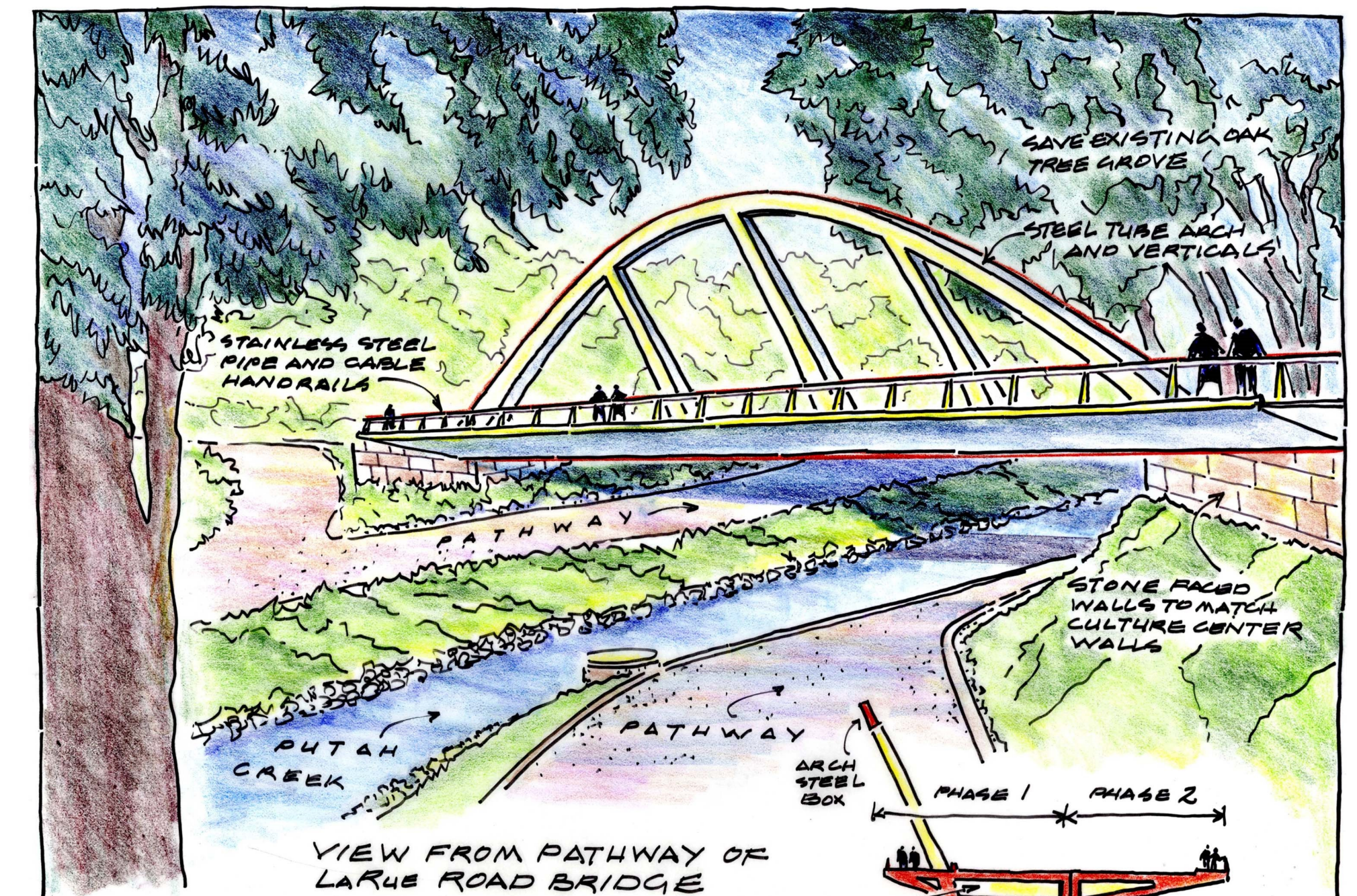

VIEW FROM PATHWAY OF  
 LARUE ROAD BRIDGE UNIVERSITY OF CALIFORNIA AT DAVIS  
 VOID FOR UTILITY CONDUITS

PROJECT CONCEPT ONLY  
 SUBJECT TO FUTURE PUBLIC REVIEW AND INPUT

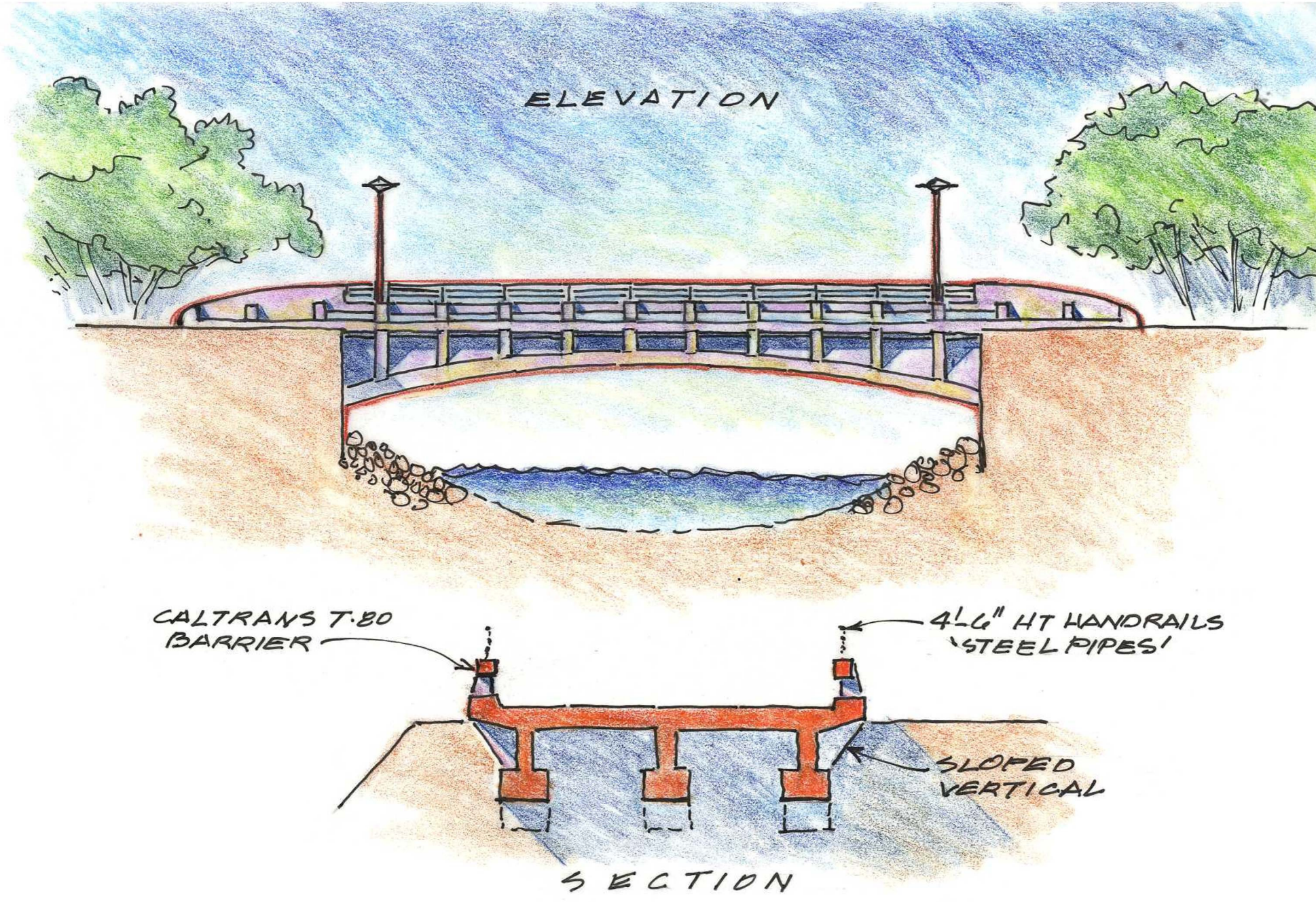

01/16 SCHEME ONE MEADOW WAY BRIDGE NOV 19/15



AZALEA AVENUE BRIDGE (REPLACEMENT) - FAIRFAX  
01/16 CONCEPT ELEVATION REFERS TO MOUNT TAMALPAIS FEB 22/16  
OPTION ONE

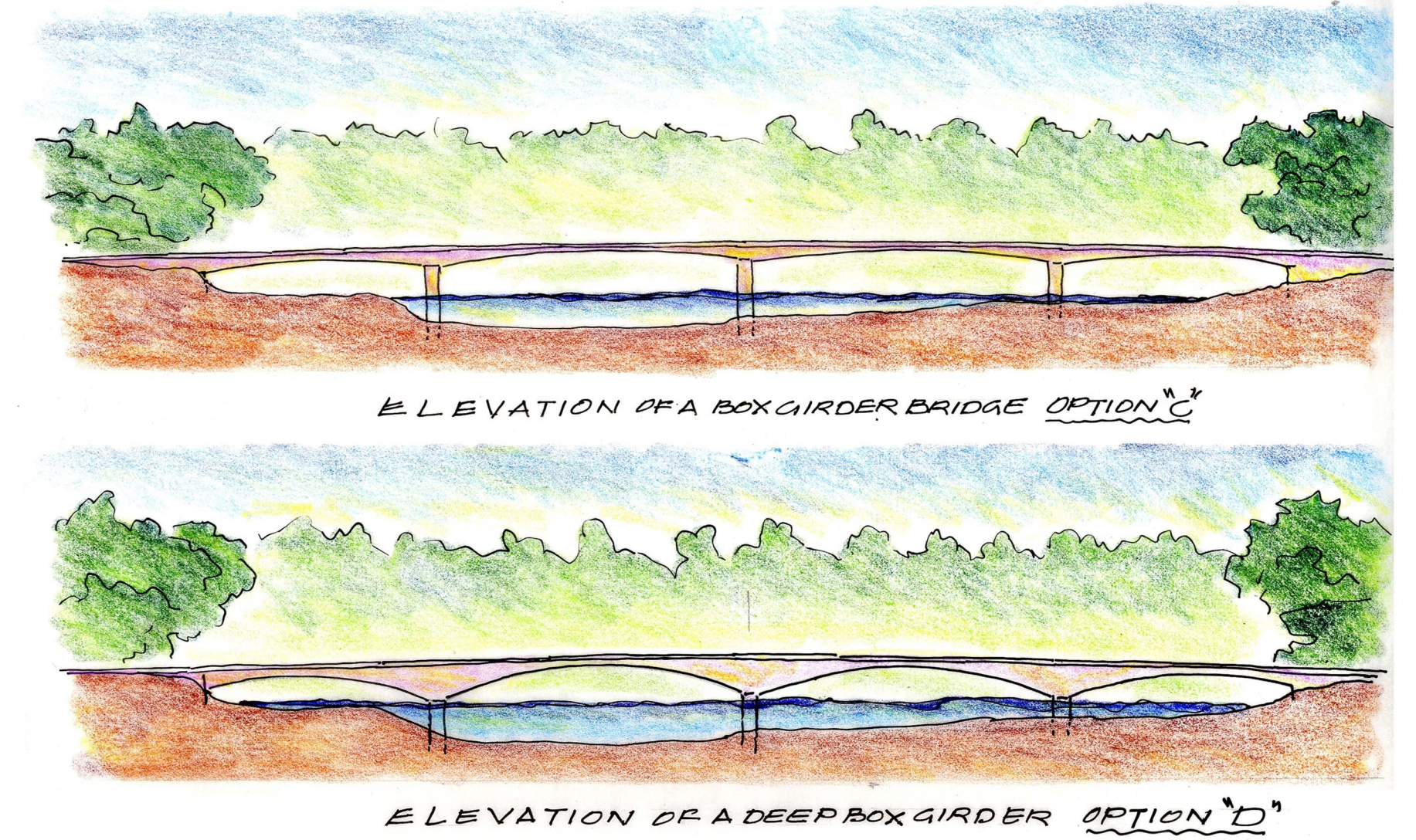

STRUCTURAL CONSIDERATIONS FOR THE MONTERIO BRIDGE  
01/16

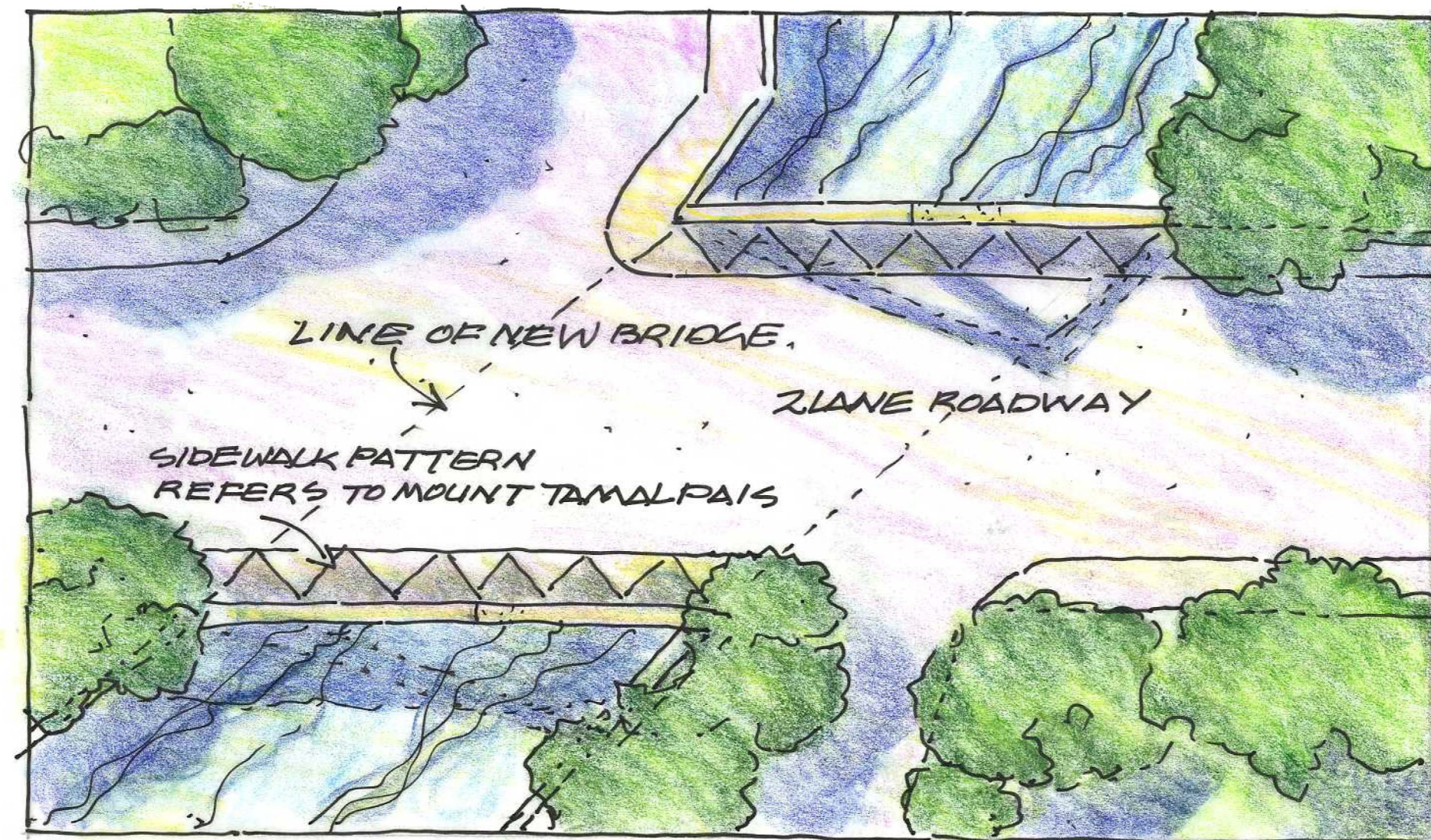

01/16 AZALEA AVENUE BRIDGE (REPLACEMENT) - FAIRFAX  
SHOWING SIDEWALK PLAN OPTION ONE FEB 22/16

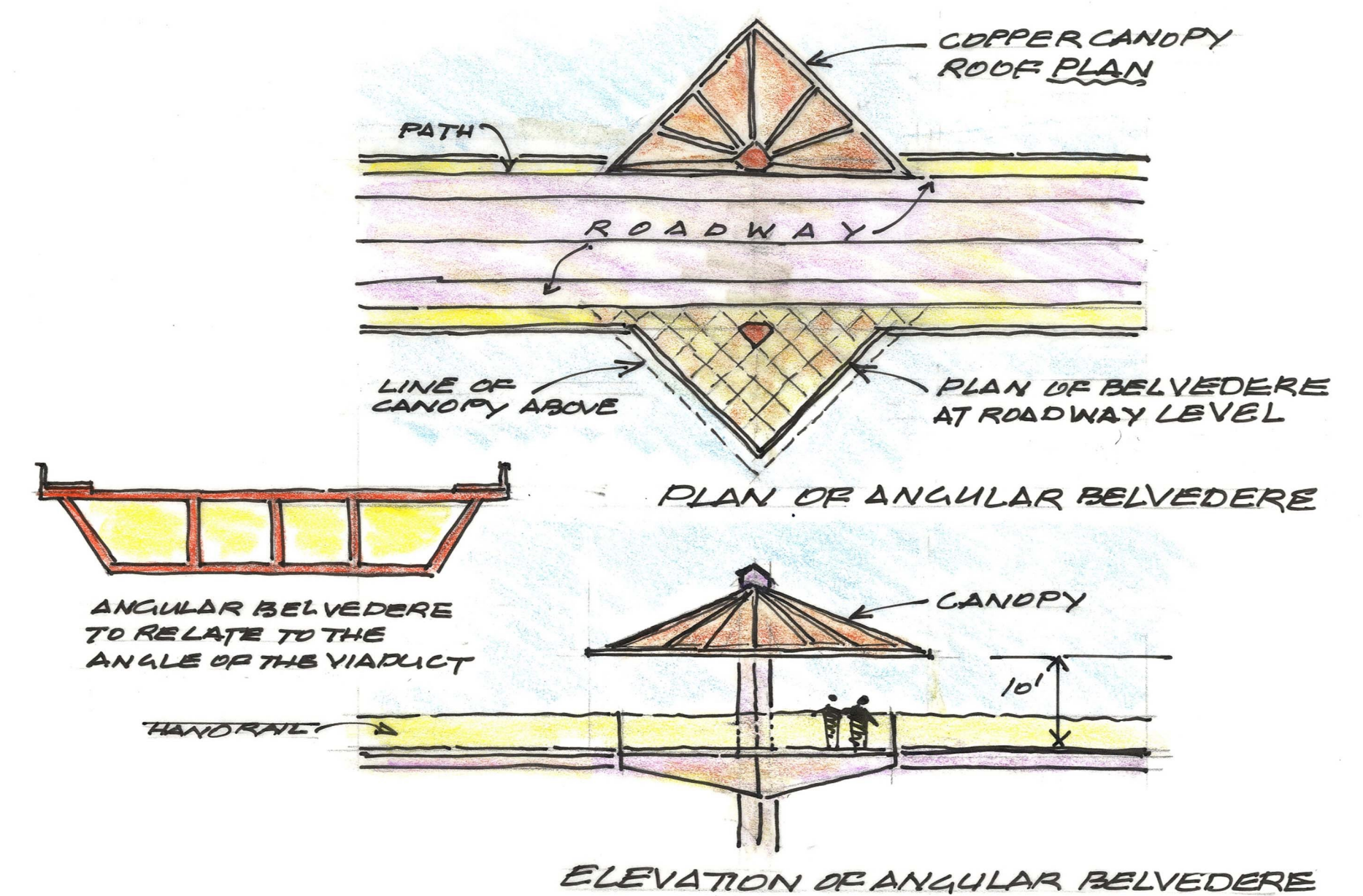

01/16 BELVEDERE OPTION ONE - MONTERIO BRIDGE



AZALEA AVENUE BRIDGE (REPLACEMENT) - FAIRFAX  
01/16 CONCEPT ELEVATION - TO EMPHASIZE ARCH FEB 22/16  
OPTION TWO

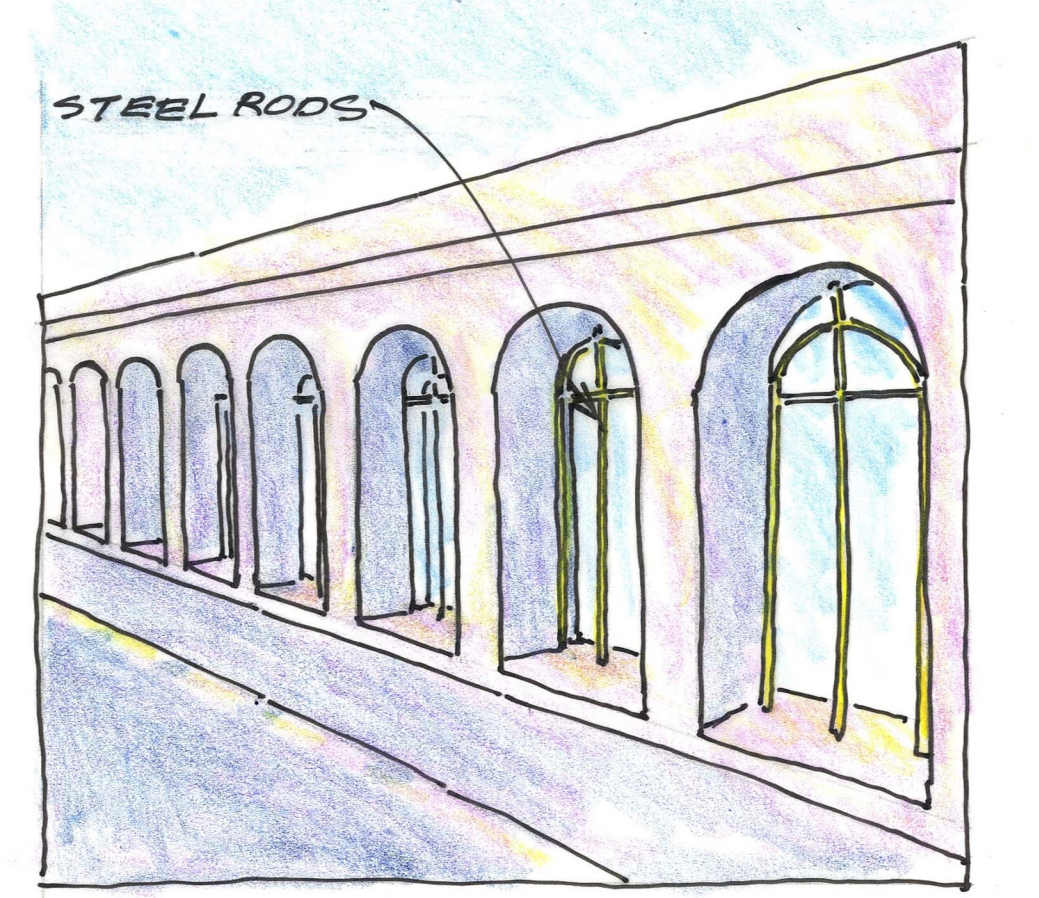
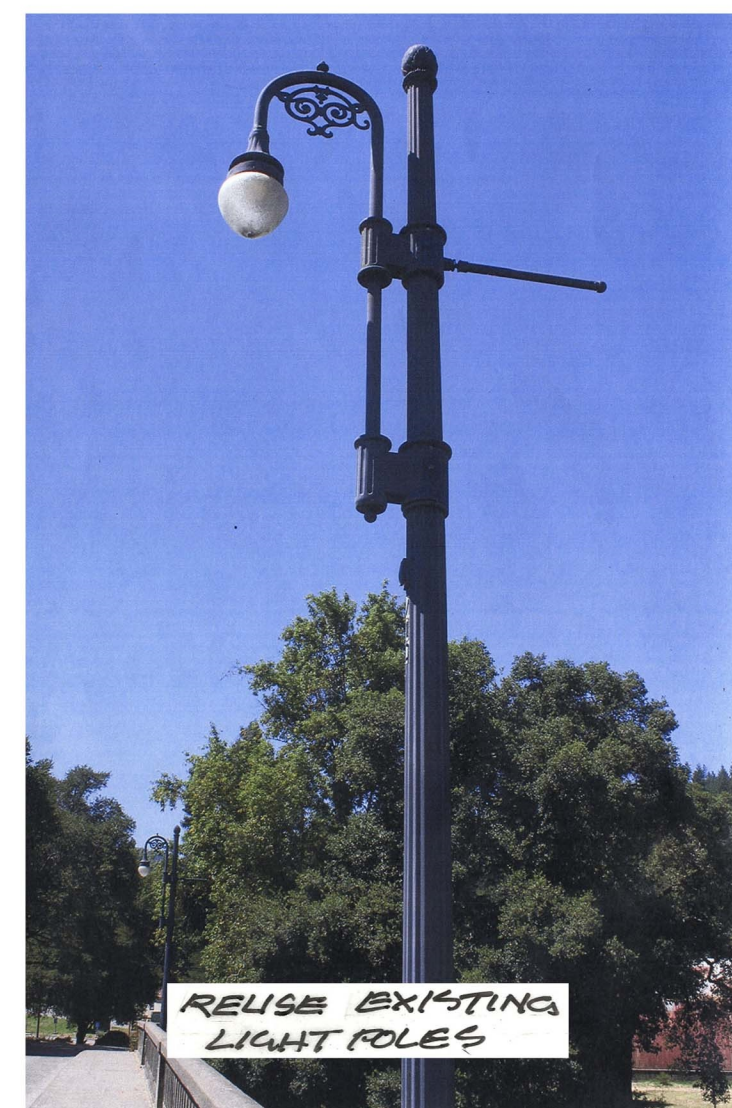

HANDRAIL AT 3RD ST. BRIDGE - NAPA  
SIMILAR TO HANDRAIL ON EXISTING BRIDGE

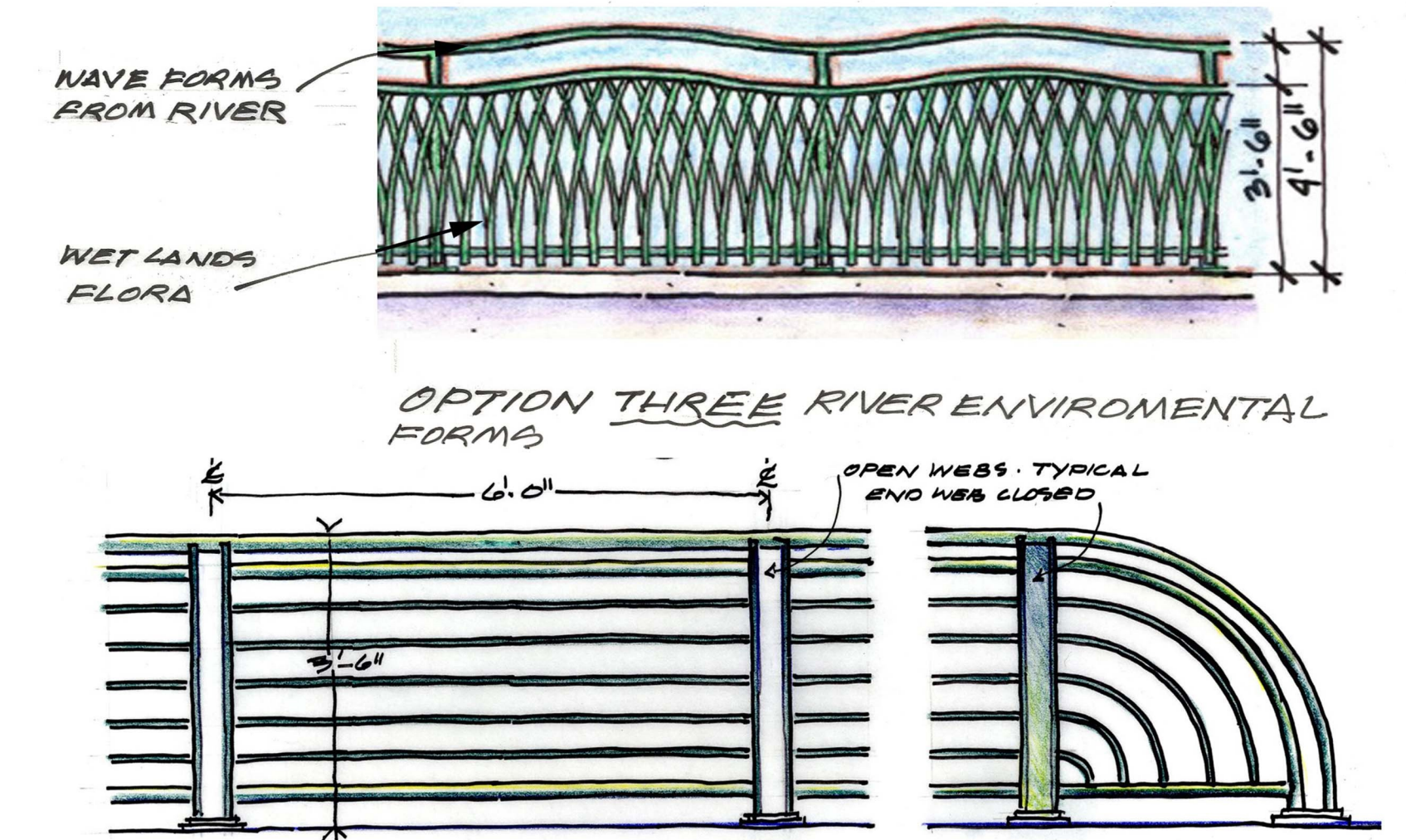

HANDRAIL OPTIONS THREE + FOUR - MONTERIO BRIDGE  
01/16

HISTORICAL ADAPTATION OF EXISTING LIGHTPOLE AND  
NEW HANDRAIL OPTION TWO - MONTERIO BRIDGE  
**PROJECT CONCEPT ONLY**  
**SUBJECT TO FUTURE PUBLIC REVIEW AND INPUT**

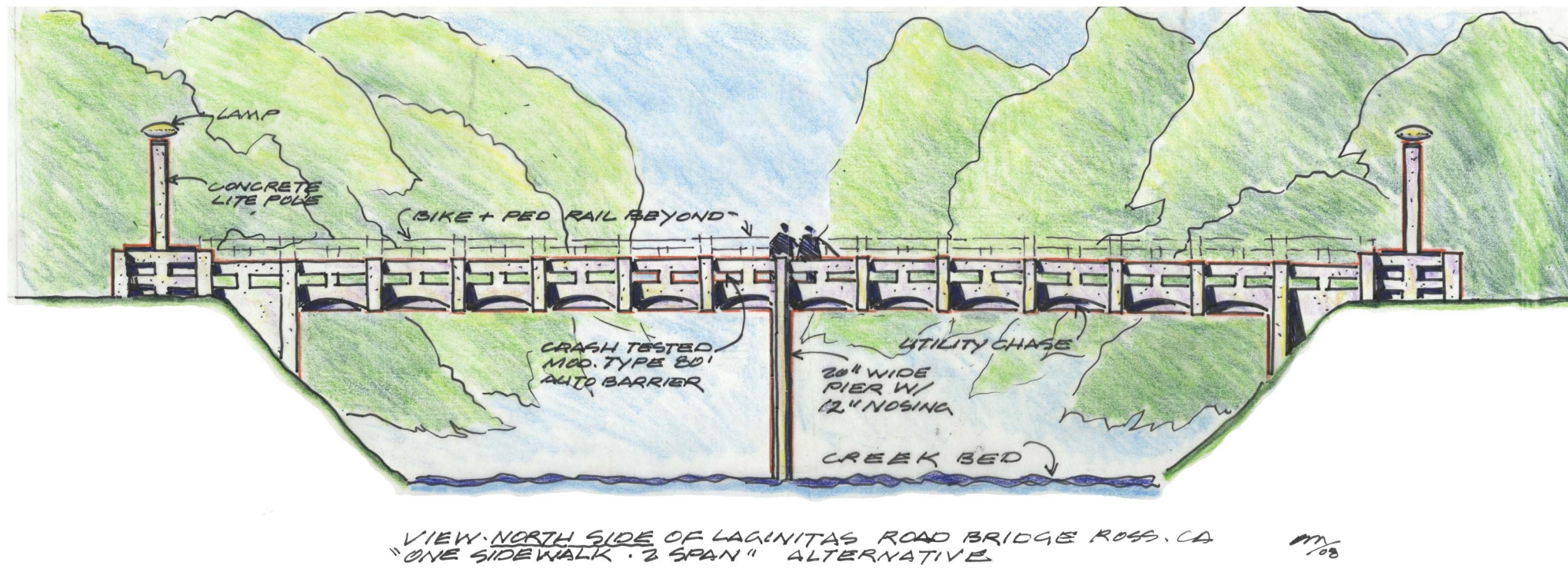

VIEW-NORTH SIDE OF LAGUNITAS ROAD BRIDGE ROSS, CA  
"ONE SIDEWALK + 3 SPAN" ALTERNATIVE  
07/15

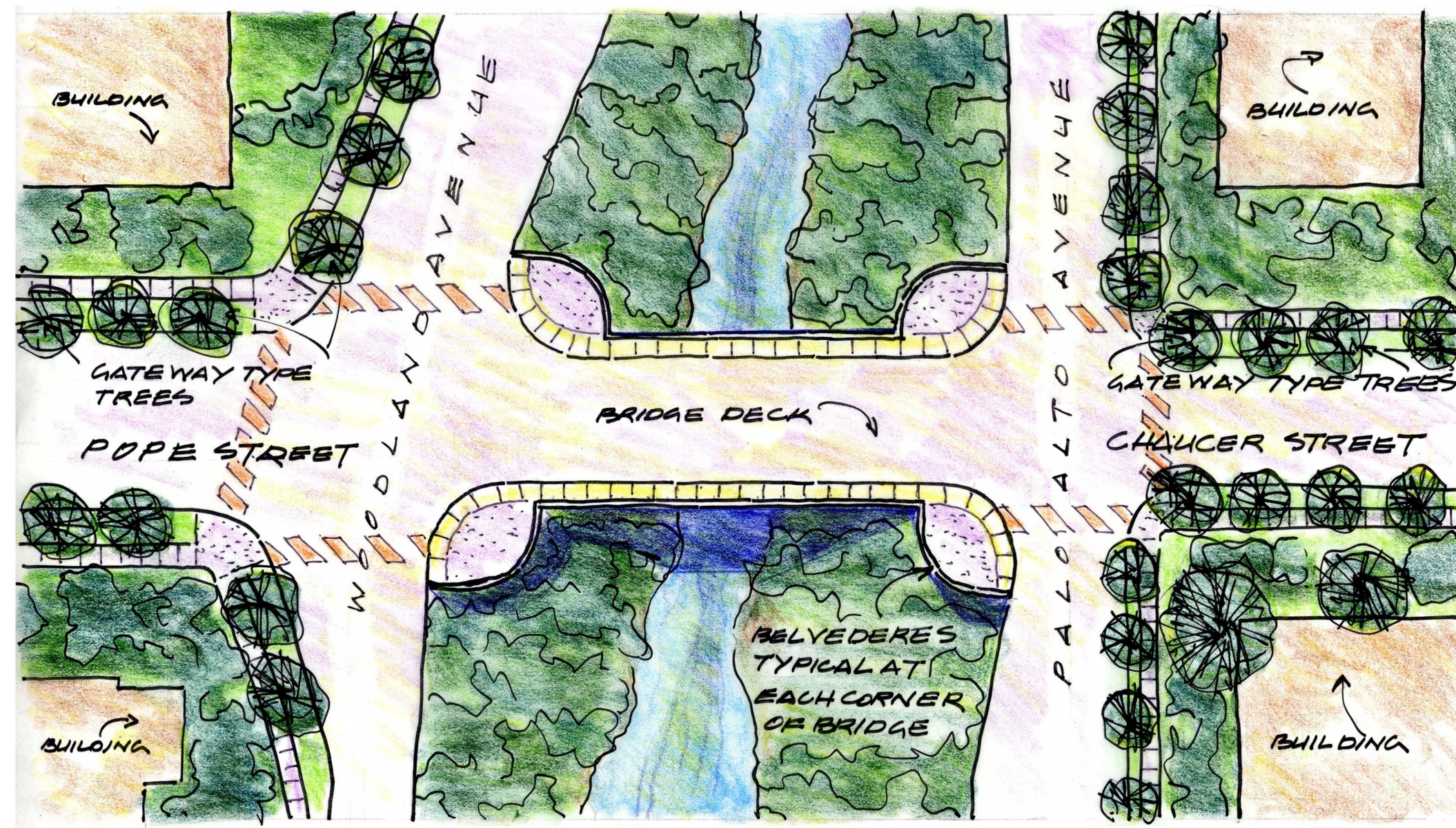

SCHEME #1. POPE/CHAUCER STREET BRIDGE REPLACEMENT  
08/12. SANTA CLARA VALLEY WATER DISTRICT 08/12

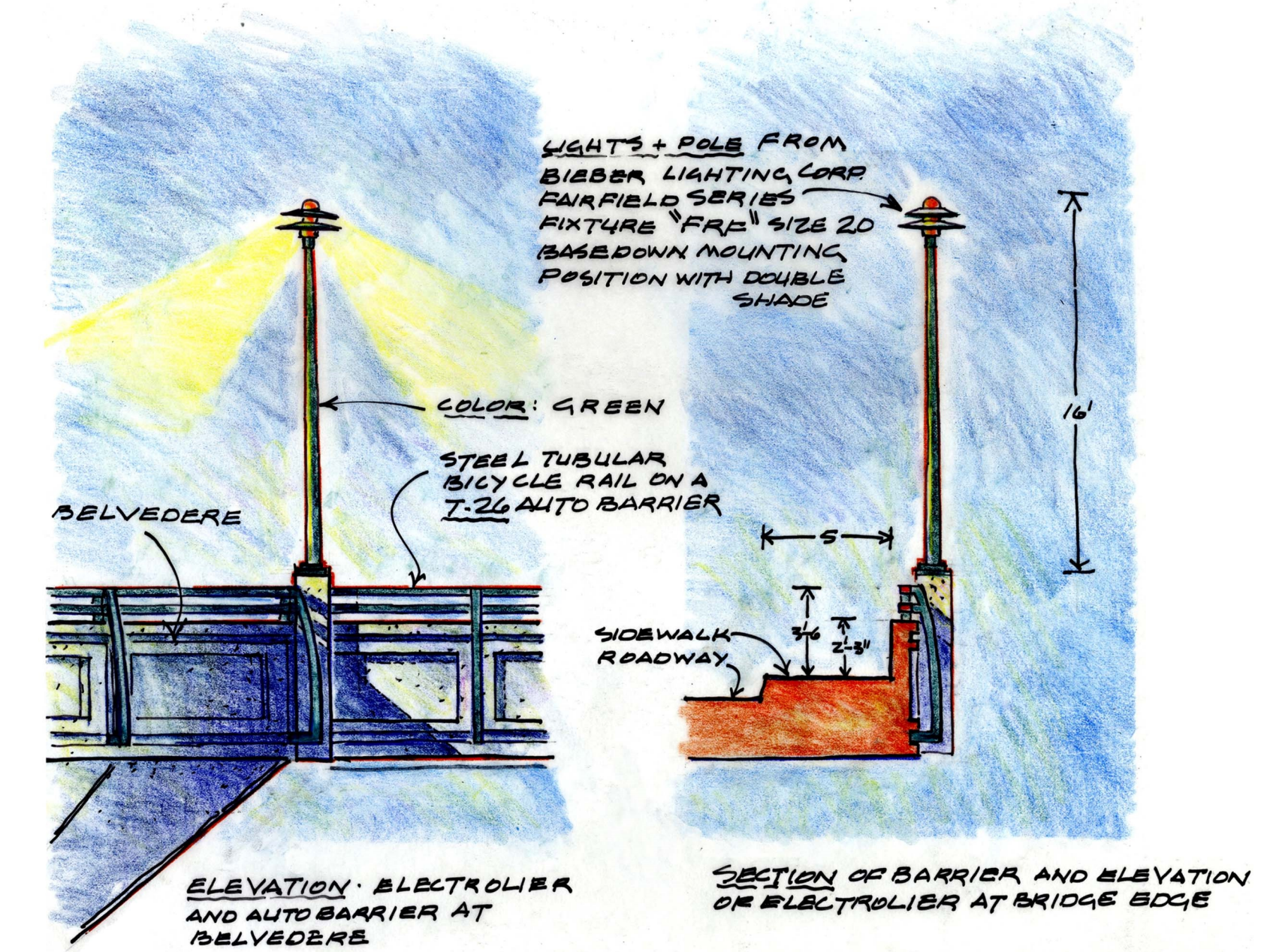

POPE/CHAUCER STREET BRIDGE REPLACEMENT  
08/15. SANTA CLARA VALLEY WATER DISTRICT 08/15

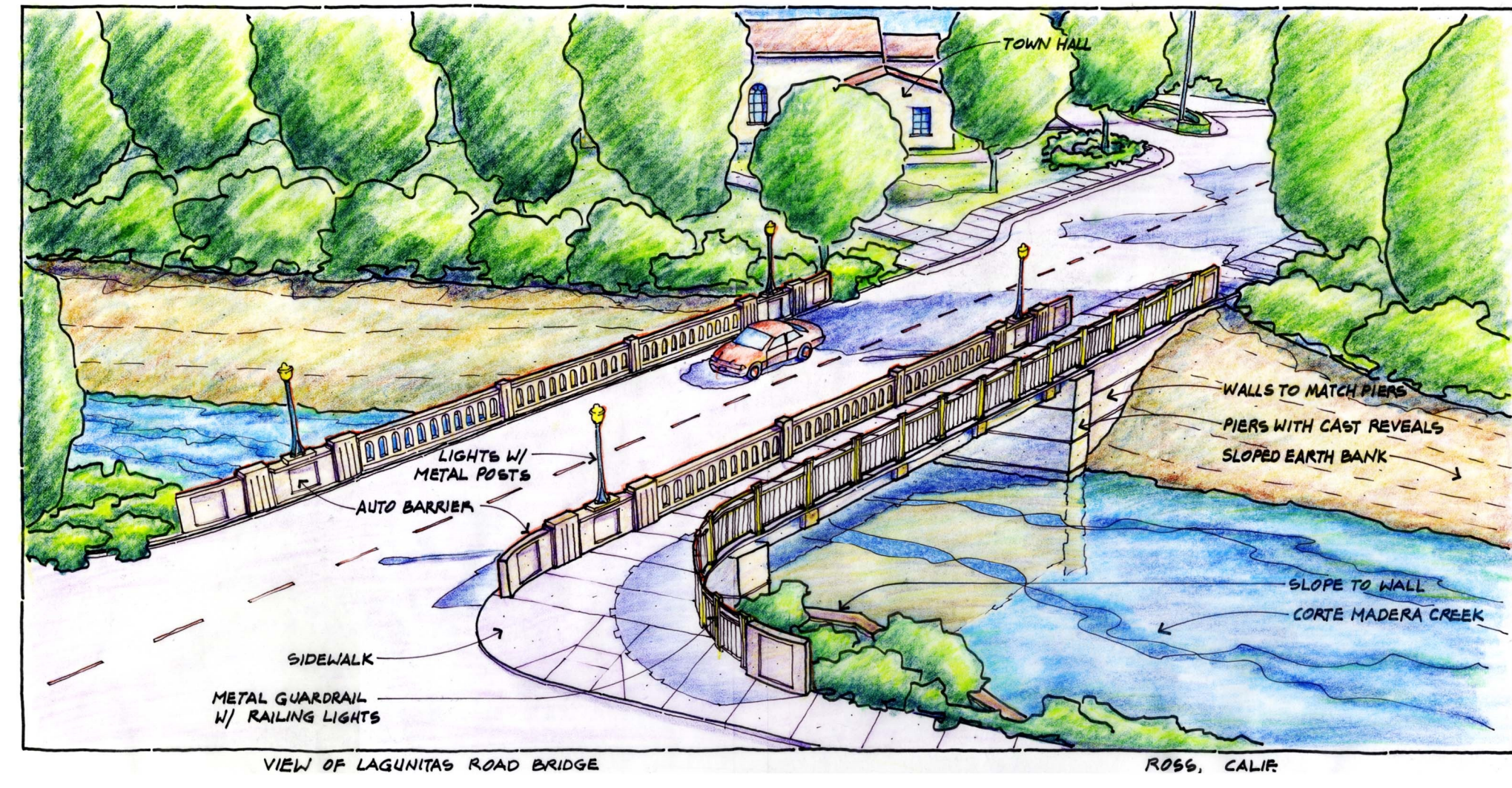

VIEW OF LAGUNITAS ROAD BRIDGE  
ROSS, CALIF 07/15

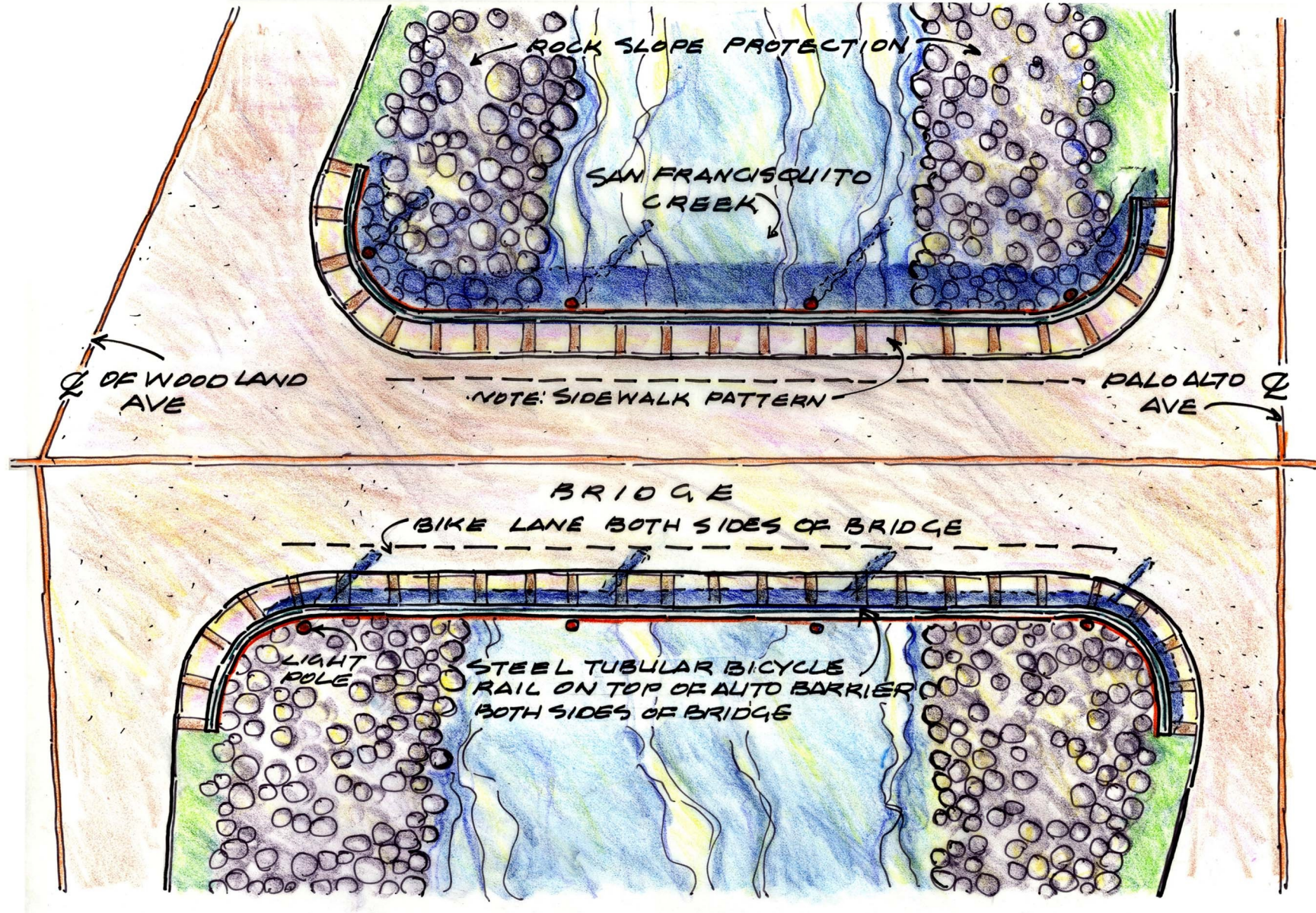

POPE/CHAUCER STREET REPLACEMENT BRIDGE  
08/15. SANTA CLARA VALLEY WATER DISTRICT 08/15

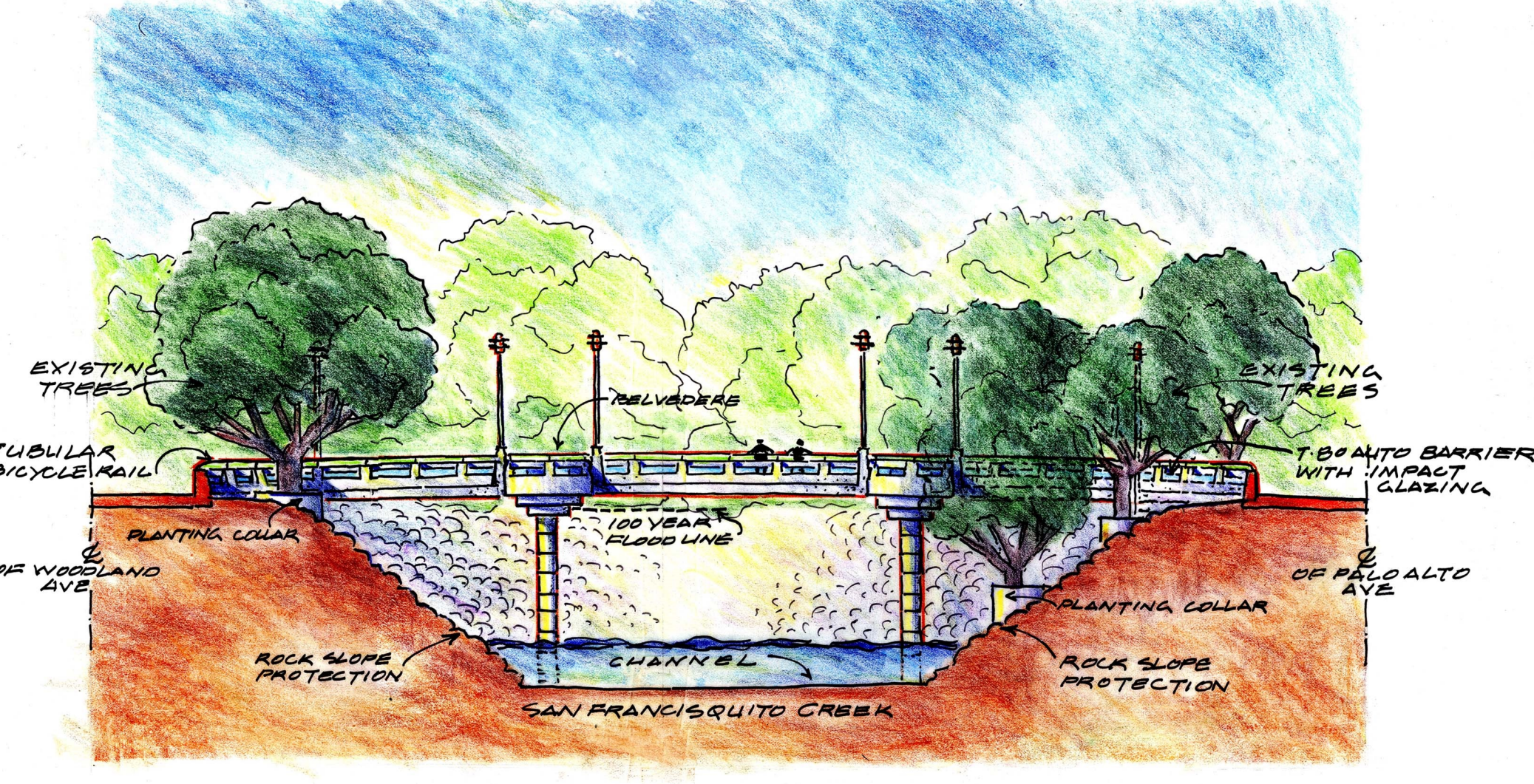

ELEVATION OF POPE/CHAUCER STREET BRIDGE REPLACEMENT  
08/15. SANTA CLARA VALLEY WATER DISTRICT 08/15

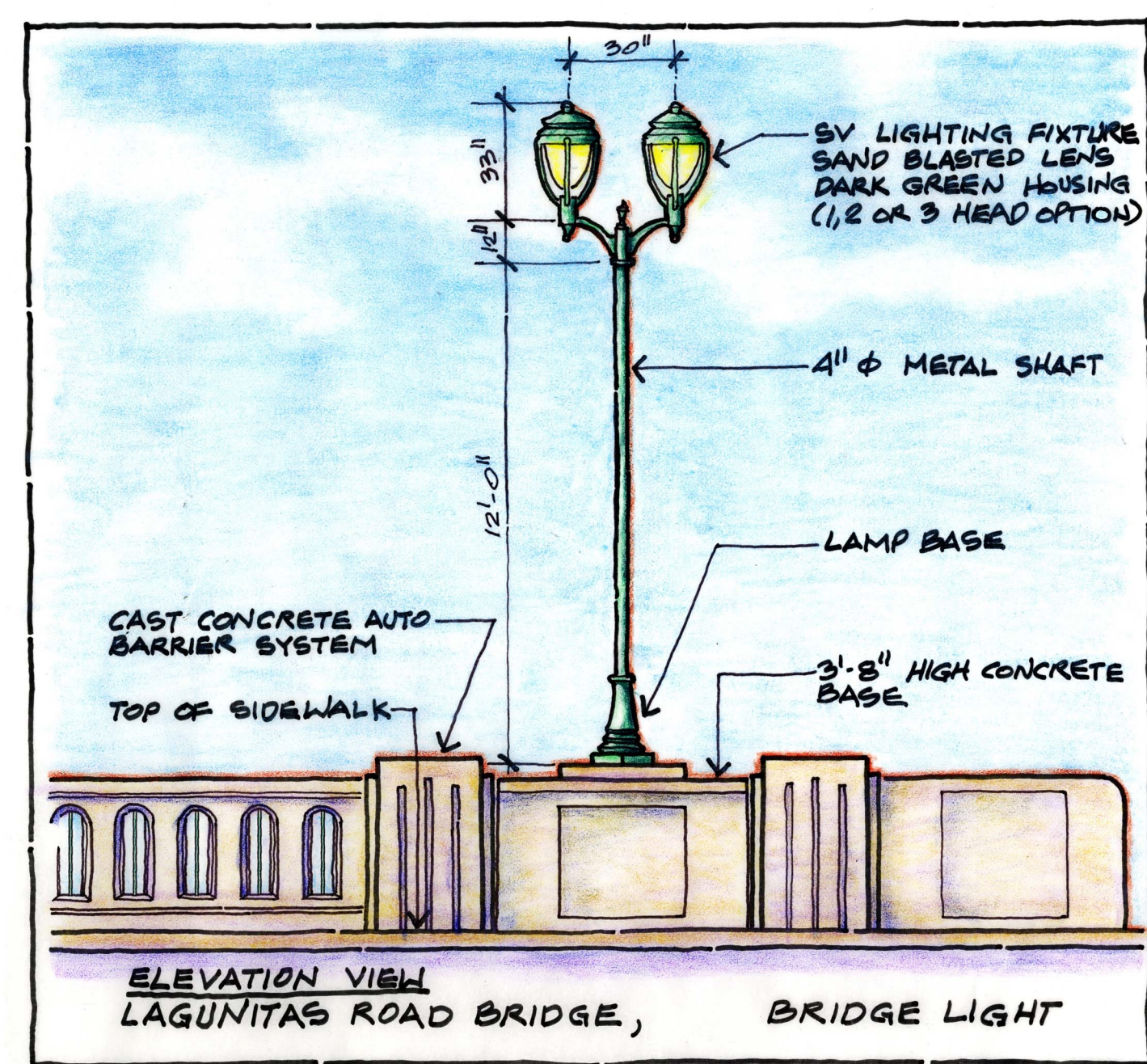

ELEVATION VIEW LAGUNITAS ROAD BRIDGE, BRIDGE LIGHT

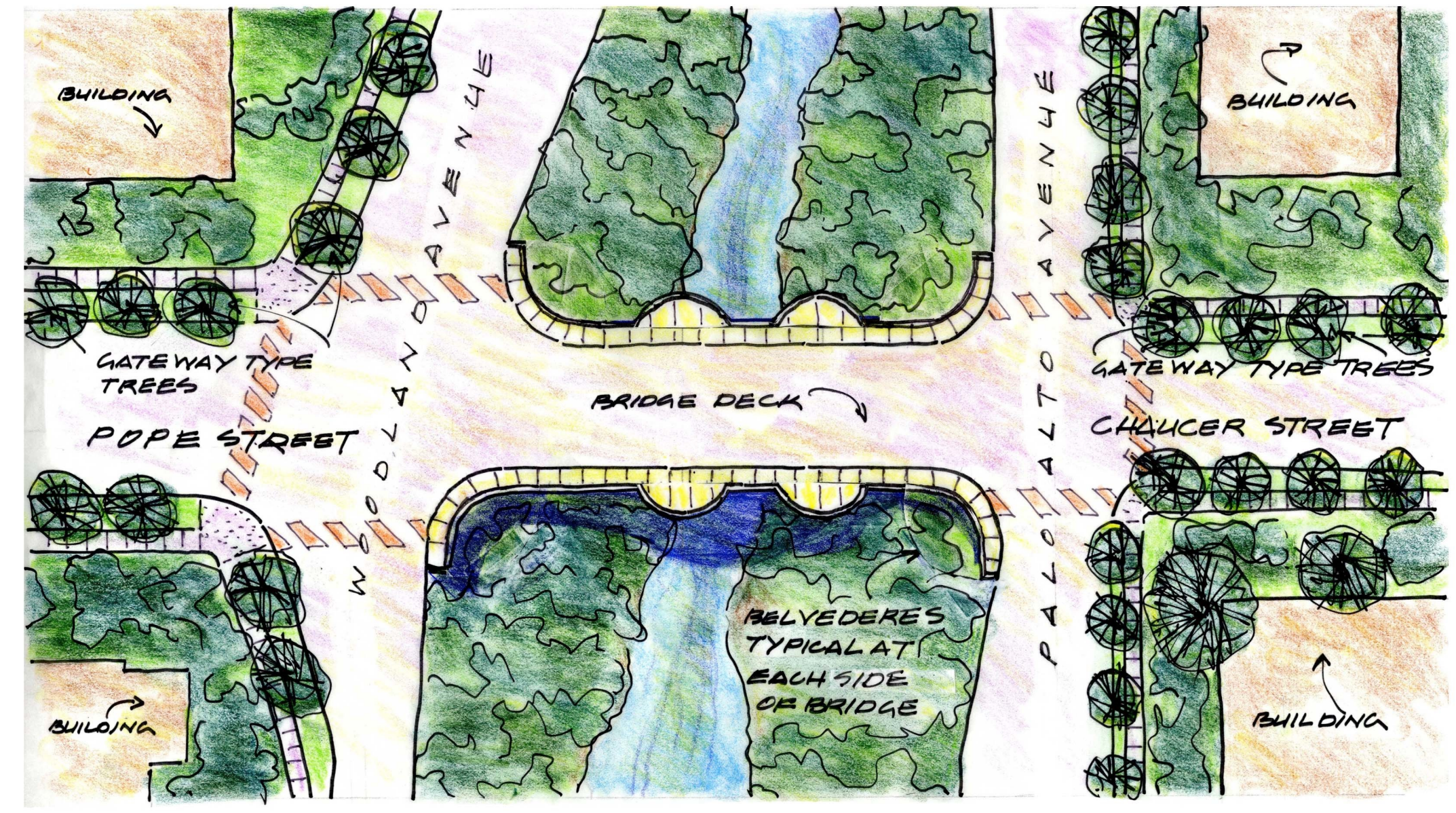

SCHEME #1. POPE/CHAUCER STREET BRIDGE REPLACEMENT  
08/15. SANTA CLARA VALLEY WATER DISTRICT 08/12

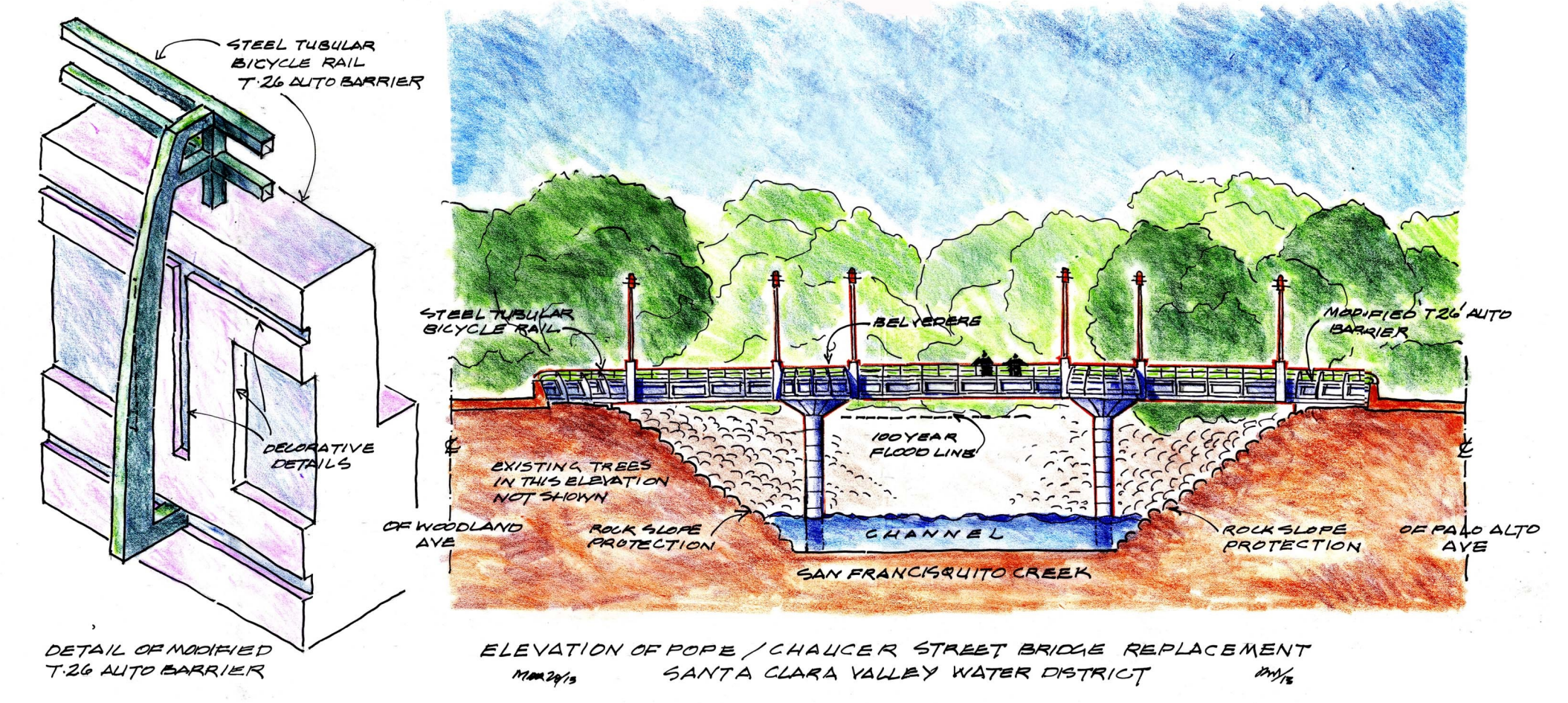

ELEVATION OF POPE/CHAUCER STREET BRIDGE REPLACEMENT  
08/15. SANTA CLARA VALLEY WATER DISTRICT 08/15

**PROJECT CONCEPT ONLY  
SUBJECT TO FUTURE PUBLIC REVIEW AND INPUT**